

DESIGNED TO
Accelerate Your Work™





Ratchets, Sockets and Drive Tools

Perfect for professionals.

The most usable tools you will ever own.

BAHCO

BAHCO® Ratchets, Sockets and Drive Tools

Designed To Handle Almost Every Job

With BAHCO® ratchets, sockets and drive tools, you can create the right tool to meet any requirement.

Ratchets that work harder with less effort.

BAHCO® ratchets incorporate all the features that make work easier including one hand reverse lever, and a design from handle to head that gives users greater comfort, control and power.

Sockets that give you a better grip.

BAHCO® sockets feature our SuperTorque® lobular opening. This design lets the socket contact the fastener on the flats of the fastener, instead of at the corners. With more contact area, you can apply greater torque with far less risk of rounding a fastener.



BAHCO® Ratchet Handles

Greater torque, comfort and convenience.

Ratchets in ¼", ⅜" and ½".



1-Piece Forged Handle
1-piece forged handle assures strength and durability; tough nickel-chrome plating adds corrosion and wear resistance.

Comfort Grip Handles
Thermoplastic handle (⅜" and ½" sizes) provides cushioned grip that gives greater comfort and less strain, along with a better grip for wet, oily or greasy hands.

Reverse Lever
Reverse lever has low profile that prevents lever from accidental bumping that can cause the ratchet to self reverse — and prevents the lever from being sheared off under torque. The elongated design is easy to operate while wearing gloves.

Low Profile Head
Low profile head permits greater accessibility in tight areas.

Release Button
Release button offers 1-handed socket disengagement, even when you're wearing gloves.

36 Gear Ratchet Tooth
36 tooth gear mechanism engages the ratchet with every 10° arc of movement, allowing quicker, easier engagement in tight spaces with less handle swing.

BAHCO® Ratchets, Sockets and Drive Tools

1/4", 3/8" and 1/2" Drive Tools

Designed to deliver more controllable torque and greater comfort, BAHCO® drive tools are constructed for a lifetime of service.

Drive Ratchet

Forged construction and precision ratchet mechanism assure dependability.



Drive Ratchet

Product Code	EAN Code 731151	Dimensions (inch) (mm)		Length (inch) (mm)	
--------------	--------------------	---------------------------	--	-----------------------	--

Drive Ratchet

800050	8253301	1/4	6	5.4	137
801050	8253325	3/8	10	8.5	216
802050	8253189	1/2	13	10.5	267

Drive Breaker Bar

802015	8253196	1/2	13	15	381
--------	---------	-----	----	----	-----

Drive Extension

Sizes up to 11" long; cold formed for strength, chrome plated for corrosion resistance.



Drive Extension

Product Code	EAN Code 731151	Dimensions (inch) (mm)		Length (inch) (mm)	
--------------	--------------------	---------------------------	--	-----------------------	--

Drive Extension

800002	8253202	1/4	6	2	51
800006	8253219	1/4	6	6	152
801003	8253226	3/8	10	3	76
801006	8253233	3/8	10	6	152
801011	8253240	3/8	10	11	279
802003	8253257	1/2	13	3.5	89
802005	8253264	1/2	13	5	127
802010	8253271	1/2	13	10	254

Spinner Handle

1/4" drive spinner permits faster tightening or loosening of fasteners. Allows 1/4" drive socket set to be used in place of nut drivers.



Spinner Handle

Product Code	EAN Code 731151	Dimensions (inch) (mm)		Length (inch) (mm)	
--------------	--------------------	---------------------------	--	-----------------------	--

Spinner Handle

800051	8253288	1/4	6	5 3/4	146
--------	---------	-----	---	-------	-----

Ratcheting Screwdriver

Reversible ratcheting mechanism combined with large comfortable handle for convenient driving power.



Ratcheting Screwdriver

Product Code	EAN Code 731151	Dimensions (inch) (mm)		Length (inch) (mm)	
--------------	--------------------	---------------------------	--	-----------------------	--

Ratcheting Screwdriver

808049	8253295	1/4	6	9	229
--------	---------	-----	---	---	-----

Drive Sockets

A highly-engineered approach that maximizes fastener contact area, accessibility, strength and life.

SuperTorque® Fastener Flats Engagement

Socket opening contacts fasteners on flats instead of just corners; provides more contact area for greater torque with less risk of fastener rounding.

Thin Wall Design

Sockets use either uniform or concentric wall thickness to eliminate weak spots, which allows thinner wall sockets that offers greater accessibility.

Large Size Markings

Permits easy size identification for the life of the tool.

Positive Detent Retention

Detents are located on all 4 inner walls for positive engagement with the drive tool in any orientation, for a tight, slop-free driving system.

Single and Double Hex Openings

- Double hex / 12-point openings ($\frac{3}{8}$ " and $\frac{1}{2}$ " drive) permit socket to engage single hex fasteners every 30° , rather than 60° for better access in restricted spaces.
- Single hex / 6-point openings ($\frac{1}{4}$ " and $\frac{3}{8}$ " drive) have more socket-to-fastener contact, to allow greater torque.

Chamfered Openings

Hex and drive ends are countersunk or funnel-shaped which allows quicker, easier engagement with between socket, fastener and drive tool.

Protective Plating

Protective plating provides superior corrosion resistance, adds wear resistance and a mirror-like finish.



BAHCO® Ratchets, Sockets and Drive Tools

1/4" and 3/8" Drive Sockets

A range of individual sizes.



Drive Sockets

Product Code	EAN Code 731151+	Size (inch)	A	Socket Type	B	C	D	E	Bolt Clearance Diameter	F	Weight (Lbs.)	(Kgs.)
1/4" Drive Standard Sockets, 6 Point												
800106	8252298	3/16"	7/8	I	15/32	5/16	5/32	17/32	3/16	7/16	0.02	0.01
800107	8252304	7/32"	7/8	I	15/32	11/32	3/16	17/32	7/32	7/16	0.02	0.01
800108	8252311	1/4"	7/8	I	15/32	3/8	7/32	17/32	7/32	7/16	0.02	0.01
800109	8252328	9/32"	7/8	I	15/32	13/32	1/4	17/32	1/4	7/16	0.02	0.01
800110	8252335	3/16"	7/8	I	15/32	7/16	9/32	17/32	1/4	7/16	0.03	0.01
800111	8252342	11/32"	7/8	II	1/2	1/2	9/32	17/32	11/32		0.03	0.01
800112	8252359	3/8"	7/8	II	17/32	17/32	9/32	17/32	3/8		0.04	0.02
800114	8252366	7/16"	7/8	II	19/32	19/32	3/8	17/32	7/16		0.04	0.02
800116	8252373	1/2"	7/8	II	11/16	11/16	3/8	17/32	1/2		0.05	0.02
800118	8252380	9/16"	7/8	II	3/4	3/4	3/8	17/32	17/32	17/32	0.06	0.03
800306	8252397	3/16"	2	I	15/32	5/16	3/16	15/32	3/16	19/16	0.04	0.02
800307	8252403	7/32"	2	I	15/32	11/32	7/32	15/32	7/32	19/16	0.04	0.02
800308	8252410	1/4"	2	I	15/32	3/8	7/32	17/32	7/32	19/16	0.04	0.02
800309	8252427	9/32"	2	I	15/32	13/32	1/4	15/32	9/32	19/16	0.05	0.02
800310	8252434	3/16"	2	I	15/32	7/16	9/32	15/32	9/32	19/16	0.06	0.03
800311	8252441	11/32"	2	II	1/2	1/2	9/32	121/32	11/32		0.06	0.03
800312	8252458	3/8"	2	II	17/32	17/32	9/32	121/32	3/8		0.08	0.04
800314	8252465	7/16"	2	II	19/32	19/32	3/8	121/32	13/32		0.09	0.04
800316	8252472	1/2"	2	II	11/16	11/16	3/8	121/32	15/32		0.12	0.05
800318	8252489	9/16"	2	II	3/4	3/4	3/8	121/32	17/32		0.14	0.06

3/8" Drive Standard Sockets, 6 Point

801112	8252496	3/8"	29/32	I	11/16	9/16	9/32	11/32	11/32	9/16	0.05	0.02
801114	8252502	7/16"	15/16	I	11/16	5/8	9/32	11/32	11/32	5/8	0.05	0.02
801116	8252519	1/2"	15/16	II	23/32	23/32	15/16	11/32	11/32		0.07	0.03
801118	8252526	9/16"	15/16	II	25/32	25/32	3/8	11/32	11/32		0.07	0.03
801120	8252533	5/8"	11/8	II	27/32	27/32	1/2	5/8	5/8		0.09	0.04
801122	8252540	11/16"	11/8	II	15/16	15/16	1/2	5/8	21/32		0.12	0.05
801124	8252557	3/4"	15/16	II	1	1	1/2	23/32	23/32		0.14	0.06
801126	8252564	13/16"	11/4	II	11/16	11/16	1/2	3/4	25/32		0.16	0.07
801128	8252571	7/8"	11/4	II	15/32	15/32	17/32	27/32	27/32		0.19	0.09

3/8" Drive Standard Sockets, 12 Point

801212	8252588	3/8"	29/32	I	11/16	9/16	9/32	11/32	11/32	9/16	0.05	0.02
801214	8252595	7/16"	15/16	I	11/16	5/8	9/32	11/32	11/32	5/8	0.05	0.02
801216	8252601	1/2"	15/16	II	23/32	23/32	15/16	11/32	11/32		0.06	0.03
801218	8252618	9/16"	15/16	II	25/32	25/32	3/8	11/32	17/32		0.07	0.03
801220	8252625	5/8"	11/8	II	27/32	27/32	1/2	5/8	5/8		0.09	0.04
801222	8252632	11/16"	11/8	II	15/16	15/16	1/2	5/8	21/32		0.11	0.05
801224	8252649	3/4"	15/16	II	1	1	1/2	23/32	23/32		0.13	0.06
801226	8252656	13/16"	11/4	II	11/16	11/16	1/2	3/4	25/32		0.16	0.07
801228	8252663	7/8"	11/4	II	15/32	15/32	17/32	27/32	27/32		0.2	0.09

Socket Types

There are two separate socket configurations. The accompanying schematics show how the dimensional information in the charts relates to each type.

Type I

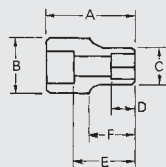

Type II

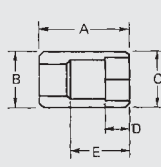

3/8" and 1/2" Drive Sockets



Drive Sockets

Product Code	EAN Code 731151+	Size (inch)	A	Socket Type	B	C	D	E	Bolt Clearance Diameter	F	Weight (Lbs.)	(Kgs.)
3/8" Drive Deep Sockets, 6 Point												
801312	8252670	3/8"	2 1/8	I	11/16	9/16	5/16	1 1/16	3/8	1 5/8	0.1	0.05
801314	8252687	7/16"	2 1/8	I	1 1/16	3/8	3/8	1 1/16	7/16	1 5/8	0.11	0.05
801316	8252694	1/2"	2 1/8	II	23/32	23/32	7/16	1 1/16	15/32		0.13	0.06
801318	8252700	9/16"	2 3/8	II	25/32	25/32	7/16	1 5/16	17/32		0.17	0.08
801320	8252717	5/8"	2 3/8	II	27/32	27/32	19/32	1 7/16	19/32		0.19	0.09
801322	8252724	1 1/16"	2 5/8	II	15/16	15/16	17/32	2 3/16	2 1/32		0.27	0.12
801324	8252731	3/4"	2 5/8	II	1	1	5/8	2 3/16	23/32		0.31	0.14
801326	8252748	13/16"	2 3/4	II	1 1/16	1 1/16	2 1/32	2 3/16	25/32		0.34	0.15
801328	8252755	7/8"	2 3/4	II	1 5/32	1 5/32	23/32	2 5/16	27/32		0.41	0.19
3/8" Drive Deep Sockets, 12 Point												
801412	8252762	3/8"	2 1/8	I	11/16	9/16	5/16	1 1/16	3/8	1 5/8	0.1	0.05
801414	8252779	7/16"	2 1/8	I	1 1/16	3/8	3/8	1 1/16	7/16	1 5/8	0.11	0.05
801416	8252786	1/2"	2 1/8	II	23/32	23/32	7/16	1 1/16	15/32		0.13	0.06
801418	8252793	9/16"	2 3/8	II	25/32	25/32	7/16	1 5/16	17/32		0.17	0.08
801420	8252809	5/8"	2 3/8	II	27/32	27/32	19/32	1 7/16	19/32		0.19	0.09
801422	8252816	1 1/16"	2 5/8	II	15/16	15/16	17/32	2 3/16	2 1/32		0.26	0.12
801424	8252823	3/4"	2 5/8	II	1	1	5/8	2 3/16	23/32		0.3	0.14
801426	8252830	13/16"	2 3/4	II	1 1/16	1 1/16	2 1/32	2 3/16	25/32		0.31	0.14
801428	8252847	7/8"	2 3/4	II	1 5/32	1 5/32	23/32	2 5/16	27/32		0.42	0.19
1/2" Drive Standard Sockets, 12 Point												
802214	8252854	7/16"	1 1/2	I	7/8	2 1/32	3/8	15/16	3/8	1 1/16	0.13	0.06
802216	8252861	1/2"	1 1/2	I	7/8	23/32	3/8	15/16	7/16	1 1/16	0.13	0.06
802218	8252878	9/16"	1 1/2	I	7/8	13/16	7/16	15/16	1/2	1 1/16	0.14	0.06
802220	8252885	5/8"	1 1/2	II	7/8	7/8	1/2	1 1/32	9/16	3/4	0.16	0.07
802222	8252892	1 1/16"	1 1/2	II	1	1	17/32	1 1/32	5/8		0.15	0.07
802224	8252908	3/4"	1 1/2	II	1 1/16	1 1/16	19/32	1 1/32	1 1/16		0.18	0.08
802226	8252915	13/16"	1 9/16	II	1 5/32	1 5/32	2 1/32	1 5/32	1 1/16		0.21	0.10
802228	8252922	7/8"	1 3/4	II	1 1/16	1 1/16	23/32	1 1/4	1 1/16		0.24	0.11
802230	8252939	15/16"	1 3/4	II	1 1/4	1 1/4	1 1/16	1 1/4	13/16		0.29	0.13
802232	8252946	1"	1 3/4	II	1 11/32	1 11/32	3/4	1 5/32	3/4		0.32	0.15
802234	8252953	1 1/16"	1 3/4	II	1 19/32	1 19/32	3/4	1 7/16	15/16		0.4	0.18
802236	8252960	1 1/8"	1 3/4	II	1 1/2	1 1/2	3/4	1 7/16	1		0.44	0.20
802238	8252977	1 3/16"	1 3/4	II	1 5/8	1 5/8	23/32	1 9/16	1 1/16		0.55	0.25
802240	8252984	1 1/4"	1 3/4	II	1 3/4	1 3/4	2 1/32	1 7/16	1 1/16		0.1	0.05
1/2" Drive Deep Sockets, 12 Point												
802414	8253028	7/16"	3 1/4	I	7/8	2 1/32	3/8	2 5/8	7/16	1 1/4	0.26	0.12
802416	8253035	1/2"	3 1/4	I	7/8	23/32	3/8	2 5/8	7/16	1 1/4	0.26	0.12
802418	8253042	9/16"	3 1/4	I	7/8	13/16	7/16	2 5/8	1/2	1 1/4	0.29	0.13
802420	8253059	5/8"	3 1/4	II	7/8	7/8	1/2	2 3/4	1/2		0.36	0.16
802422	8253066	1 1/16"	3 1/4	II	1	1	17/32	2 23/32	2 1/32		0.35	0.16
802424	8253073	3/4"	3 1/4	II	1 1/16	1 1/16	19/32	2 2 1/32	5/8		0.42	0.19
802426	8253080	13/16"	3 1/4	II	1 5/32	1 5/32	2 1/32	2 2 1/32	3/4		0.49	0.22
802428	8253097	7/8"	3 1/4	II	1 1/16	1 1/16	23/32	2 2 1/32	25/32		0.53	0.24
802430	8253103	15/16"	3 1/4	II	1 1/4	1 1/4	1 1/16	2 2 1/32	13/16		0.63	0.29
802432	8253110	1"	3 1/4	II	1 11/32	1 11/32	3/4	2 2 1/32	29/32		0.67	0.30
802434	8253127	1 1/16"	3 1/4	II	1 19/32	1 19/32	3/4	2 2 1/32	3 1/32		0.79	0.36
802436	8253134	1 1/8"	3 1/4	II	1 1/2	1 1/2	3/4	2 2 1/32	1 1/32		0.86	0.39
802438	8253141	1 3/16"	3 1/2	II	1 5/8	1 5/8	23/32	2 2 1/32	1 1/32		1	0.45
802440	8253158	1 1/4"	3 1/2	II	1 3/4	1 3/4	2 1/32	2 2 1/32	1 1/32		1	0.45

BAHCO® Ratchets, Sockets and Drive Tools

1/4" and 3/8" Fractional Size Drive Socket Sets

The most commonly-needed sockets, ratchets and drive tools, packaged together for go-anywhere convenience.

1/4" Drive Set 803114

Product Code	EAN Code 731151	Description
14 Piece	8251079	
800050		Ratchet
800002		2" Extension
800006		6" Extension
800051		Spinner Handle
800106		Standard Socket, 6-PT, 3/16
800107		Standard Socket, 6-PT, 7/32
800108		Standard Socket, 6-PT, 1/4
800109		Standard Socket, 6-PT, 9/32
800110		Standard Socket, 6-PT, 5/16
800111		Standard Socket, 6-PT, 11/32
800112		Standard Socket, 6-PT, 3/8
800114		Standard Socket, 6-PT, 7/16
800116		Standard Socket, 6-PT, 1/2
800118		Standard Socket, 6-PT, 5/8
		Zippered Canvas Pouch

3/8" Drive Set 804112

Product Code	EAN Code 731151	Description
12 Piece	8251086	
801050		Ratchet
801003		3" Extension
801006		6" Extension
801112		Standard Socket, 6-PT, 3/8
801114		Standard Socket, 6-PT, 7/16
801116		Standard Socket, 6-PT, 1/2
801118		Standard Socket, 6-PT, 9/16
801120		Standard Socket, 6-PT, 5/8
801122		Standard Socket, 6-PT, 11/16
801124		Standard Socket, 6-PT, 3/4
801126		Standard Socket, 6-PT, 13/16
801128		Standard Socket, 6-PT, 7/8
		Zippered Canvas Pouch

3/8" Drive Set 804921

Product Code	EAN Code 731151	Description
21 Piece	8251093	
801050		Ratchet
801003		3" Extension
801006		6" Extension
801112		Standard Socket, 6-PT, 3/8
801114		Standard Socket, 6-PT, 7/16
801116		Standard Socket, 6-PT, 1/2
801118		Standard Socket, 6-PT, 9/16
801120		Standard Socket, 6-PT, 5/8
801122		Standard Socket, 6-PT, 11/16
801124		Standard Socket, 6-PT, 3/4
801126		Standard Socket, 6-PT, 13/16
801128		Standard Socket, 6-PT, 7/8
801312		Deep Socket, 6-PT, 3/8
801314		Deep Socket, 6-PT, 7/16
801316		Deep Socket, 6-PT, 1/2
801318		Deep Socket, 6-PT, 9/16
801320		Deep Socket, 6-PT, 5/8
801322		Deep Socket, 6-PT, 11/16
801324		Deep Socket, 6-PT, 3/4
801326		Deep Socket, 6-PT, 13/16
801328		Deep Socket, 6-PT, 7/8
		Zippered Canvas Pouch



1/2" Fractional Size Drive Socket Sets

The sets for bigger, tougher applications when it takes the strongest, most durable drives and sockets to do the job.

805212



1/2" Drive Set 805212

Product Code	EAN Code	Description
12 Piece 8251009		
802050		Ratchet
802005		5" Extension
802214		Standard Socket, 12-PT, 7/16
802216		Standard Socket, 12-PT, 1/2
802218		Standard Socket, 12-PT, 9/16
802220		Standard Socket, 12-PT, 5/8
802222		Standard Socket, 12-PT, 11/16
802224		Standard Socket, 12-PT, 3/4
802226		Standard Socket, 12-PT, 13/16
802228		Standard Socket, 12-PT, 7/8
802230		Standard Socket, 12-PT, 15/16
802232		Standard Socket, 12-PT, 1
802233		Zippered Canvas Pouch

805217



1/2" Drive Set 805217

Product Code	EAN Code	Description
17 Piece 8251116		
802050		Ratchet
802015		Breaker Bar
802005		5" Extension
802214		Standard Socket, 12-PT, 7/16
802216		Standard Socket, 12-PT, 1/2
802218		Standard Socket, 12-PT, 9/16
802220		Standard Socket, 12-PT, 5/8
802222		Standard Socket, 12-PT, 11/16
802224		Standard Socket, 12-PT, 3/4
802226		Standard Socket, 12-PT, 13/16
802228		Standard Socket, 12-PT, 7/8
802230		Standard Socket, 12-PT, 15/16
802232		Standard Socket, 12-PT, 1
802234		Standard Socket, 12-PT, 1 1/16
802236		Standard Socket, 12-PT, 1 1/8
802238		Standard Socket, 12-PT, 1 1/16
802240		Standard Socket, 12-PT, 1 1/4
802233		Zippered Canvas Pouch